

GAS CAPSULE

R445.999.102

Series : **GDT**

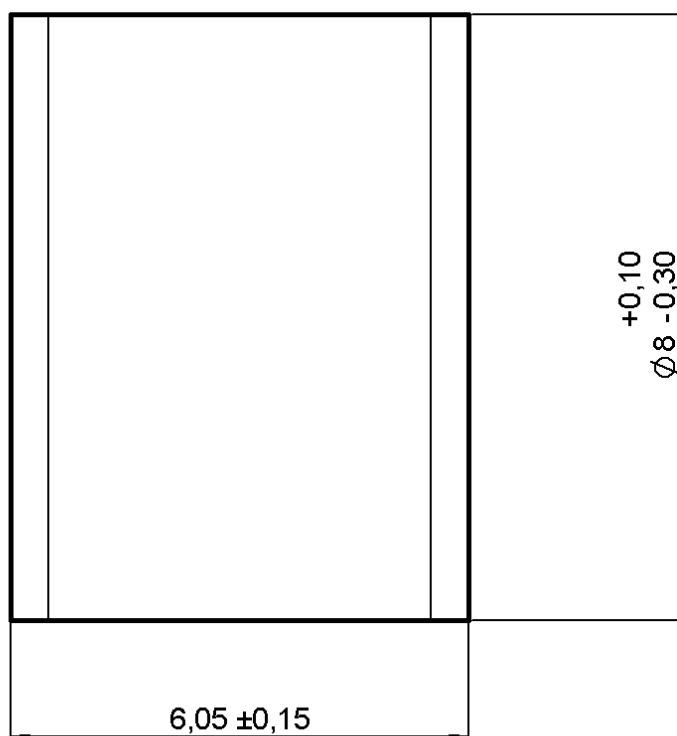

All dimensions are in mm.



COMPONENTS	MATERIALS	PLATINGS (µm)
ELECTRODES	METAL	-
INSULATOR	CERAMIC	-
-	-	-
-	-	-
-	-	-
-	-	-
-	-	-

Issue : 0046 A

In the effort to improve our products, we reserve the right to make changes judged to be necessary.



GAS CAPSULE**R445.999.102**Series : **GDT****PACKAGING**

Standard	Unit	Other
1		Contact us

ELECTRICAL CHARACTERISTICSNominal DC spark-over voltage : **90 V +/- 20%**Impulse spark-over voltage at 1 kV/ μ s : **< 600 V**Nominal impulse discharge current (wave 8/20 μ s) : **20 kA**Nominal alternating discharge current (50Hz, 1s) : **20 A**Insulation resistance : **10¹⁰ Ohm at 50 V**Capacitance : **< 1.5 pF****MECHANICAL CHARACTERISTICS**Weight **1.500 g****ENVIRONMENTAL**Operating temperature : **-40 / 100 °C**Storage temperature : **-40 / 100 °C**Relative humidity : **10 to 95%**Climatic category (IEC 68-1) : **40/100/21****Issue : 0046 A**

In the effort to improve our products, we reserve the right to make changes judged to be necessary.

